



# CASING BALL VALVES



**FIELD PROVEN VALVES PROVIDING YEARS  
OF COST EFFECTIVE, EFFICIENT, SAFE AND  
RELIABLE SERVICE.**



# CASING BALL VALVES

## Manufactured in compliance with:

- API 5B
- ASME B3.1 Pipe Threads
- NACE MR0175-2003

## Limited compliance to:

- ASME B16.34 Wall Thickness
- ASME B&PVC Sections 2 and 8
- Design and Material Requirements
- API 6D and API 6A Design Requirements
- API 608

Carbon Steel - Ductile Iron - Stainless Steel



## FEATURES

- Long form Casing Threads.
- Ductile Iron, Carbon Steel or Stainless Steel.
- Ductile Iron: 2000 WOG Pressure Range
- Carbon Steel : 3000 WOG Pressure Range
- Stainless Steel : 3000 WOG Pressure Range
- 4", 5" and 7" casing thread sizes.
- Field Repairable

ISO 9001:2000 Certified  
Certificate No. C2007-01814



**Casing Ball Valves** by Tulsa Valve were originally developed for the casing plunger industry, however our Casing Ball Valve now enjoys service in many other applications throughout the valve industry.

Tulsa Valve Casing Ball Valves provide the oil patch with a dependable, trouble free, quality Casing Ball Valve.

Our Casing Ball Valve incorporates many features which include a backseated stem that is blowout proof. The stem area is grease-packed and protected by our external stop plate which serves two purposes: to guard the stem from external elements, and to give dual precise stopping support during opening and closing. Made with Long Casing Threads for easy use. All of our Casing Ball Valves conform to NACE MR0175 requirements. Tulsa Valve performs 100% pressure testing on all of our Casing Ball Valves.

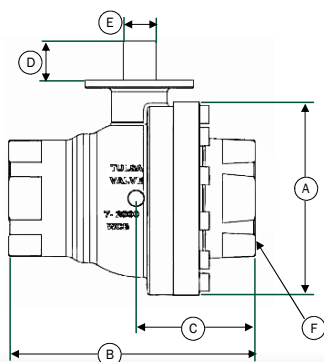

## MATERIAL SPECIFICATIONS

Size	Material	Cat. No.	Port	W.P.	A	B	C	D	E	F
	Ductile Iron	4F-E44DI8R	4	2000	9 11/16	13 1/4	6 1/16	1 3/8	1.37	8 Round
4 x 4 x 4	Ductile Iron	4F-E44DI8V	4	2000	9 11/16	13 1/4	6 1/16	1 3/8	1.37	8 V
	Carbon Steel	4F-E44CS8R	4	3000	9 11/16	13 1/4	6 1/16	1 3/8	1.37	8 Round
5 x 5 x 5	Ductile Iron	5F-E55DI8R	5	2000	11 1/4	16 3/8	6 7/8	1 3/8	1 3/8	8 Round
	Stainless Steel	5F-E55SS8R	5	3000	11 1/4	16 3/8	6 7/8	1 3/8	1 3/8	8 Round
6 x 6 x 6	Carbon Steel	7F-E77CS8R	7	3000	14 3/4	18 3/4	8 13/16	3	2.5	8 Round

**SINCE 1992 WE HAVE BUILT OUR REPUTATION ACROSS THE OIL AND GAS INDUSTRY FOR PRODUCING VALVES WITH OUTSTANDING PERFORMANCE AND COMPETITIVE PRICING.**

PART NAME	
	CV
1	Body
2	Ball
3	Stem
4	Seat
5	Stem O'Ring
6	Thrust Bearing
7	Stop Plate (not shown)
8	Snap Ring (not shown)
9	Body Bolts
10	Adapter
11	Adapter O'Ring

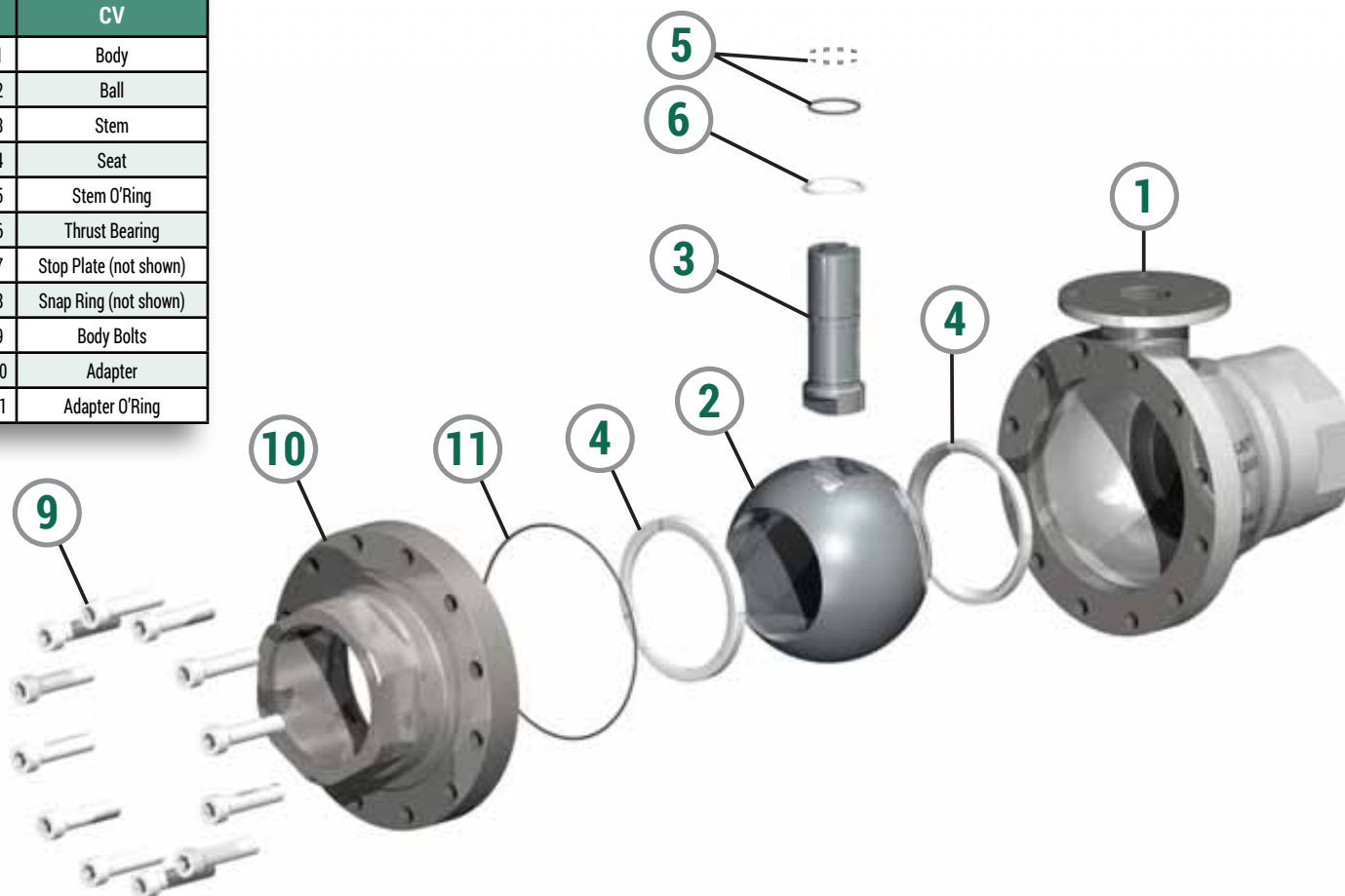

DIMENSIONS / SPECIFICATIONS				
	Part	Ductile Iron	Carbon Steel	Stainless Steel
1	Body	ASTM A395 Ductile Iron	ASTM 352 LCC Carbon Steel	ASTM A351 Stainless Steel
2	Ball	ASTM A351 Stainless Steel	ASTM A351 Stainless Steel	ASTM A351 Stainless Steel
3	Stem	4140 Zinc Plated	316 SS Annealed	316 SS Annealed
4	Seat	Nylon (RTFE Optional)	Nylon (RTFE Optional)	Nylon (RTFE Optional)
5	Stem O'Ring	Buna-N 70 Duro (Viton Optional)	Buna-N 70 Duro (Viton Optional)	Buna-N 70 Duro
6	Thrust Bearing	PTFE	PTFE	PTFE
7	Stop Plate	A36 CS Plated	A36 CS Plated	A36 CS Plated
8	Snap Ring	Spring Steel	Spring Steel	Spring Steel
9	Body Bolts	ASTM A574 (SAE Grade 5 on 7")	ASTM A193 B7M	ASTM A193 B8M
10	Adapter	ASTM A395 Ductile Iron	ASTM 352 LCC Carbon Steel	ASTM A351 Stainless Steel
11	Adapter O'Ring	Viton 75 Duro	Viton 75 Duro	Viton 75 Duro

**BY UTILIZING OUR EXTENSIVE BACKGROUND AND EXPERTISE IN DESIGN AND MANUFACTURING, WE HAVE PROVIDED MANY SPECIALTY VALVES IN THE VARIOUS OILFIELD ENVIRONMENTS WORLDWIDE.**





## LEADERS IN THE VALVE INDUSTRY

Tulsa Valve is a USA based OEM for a wide range of commonly used valves. The increasing demands to design valves that are more efficient, along with ease of operation, have put Tulsa Valve into a leading position in the industry.



## GUARANTEED AGAINST DEFECTS



Tulsa Valve products are guaranteed against defects of material workmanship for One (1) Year from date of invoice provided such products are used normally and within the service and pressure range for which they were manufactured. This guarantee is limited to the repair, replacement or repayment of purchase price. Under no conditions will Tulsa Valve be liable for claim of labor for removal, repair or replacement of Tulsa Valve products, or any other consequential damage.

HOUSTON, TEXAS

TEL: (281) 909-3711 • FAX: (281) 306-2526

[WWW.TULSAVALVE.COM](http://WWW.TULSAVALVE.COM)