



BOLTED BODY BALL VALVES

FEATURES

- Lever Operated Ball Valve
- 3,000 to 5,000 PSI WP
- 2" Reduced and Full Ports
- Bolted Body Construction
- Carbon Steel with Stainless Internals

ISO 9001:2000 Certified
Certificate No. C2007-01814

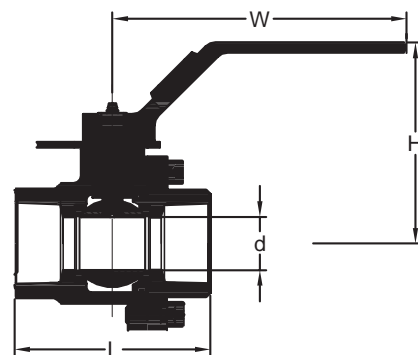
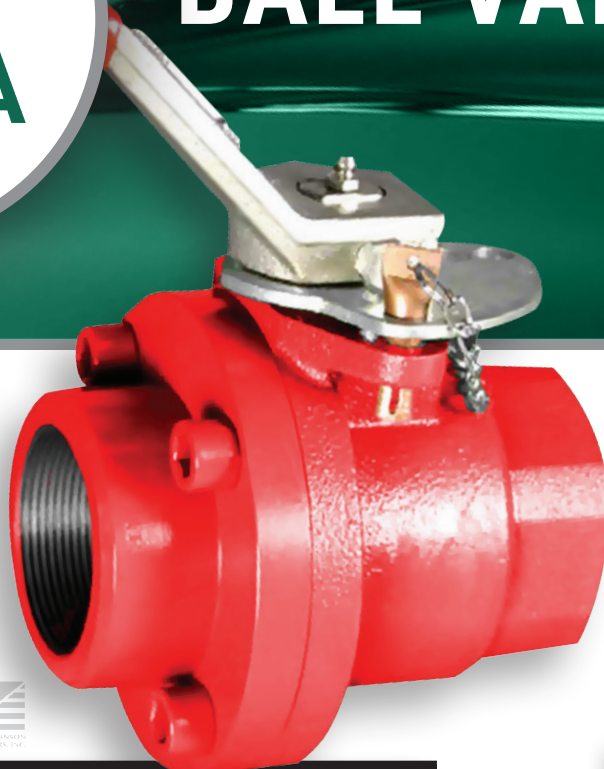

PRODUCT DIMENSIONS

SIZE	d	L	W	H
2" RP	1.50	5.51	8.27	5.67
2" FP	2.01	6.02	10.63	5.87

MAIN PARTS AND MATERIAL SPECIFICATIONS

No	Part	Carbon Steel
1	Body	A216 WCB
2	Adapter	A216 WCB
3	Stem	SS 304/ SS316
4	Ball	SS 304/ SS316
5	Body Seal	VITON
6	Stem Bearing	PTFE
7	Seal	DELTRIN/PEEK
8	Stop pin	STEEL
9	Stem seal	VITON
10	Thrust bearing	PTFE
11	Handle	DUCTILE IRON
12	Stop Plate	STEEL
13	Circlip	SPRING STEEL
14	Handle bolt	CARBON STEEL
15	Stop Pin	BRASS
16	Retaining Ring	STEEL
17	Grease Zert	STEEL
18	Bolt	HARDENED STEEL

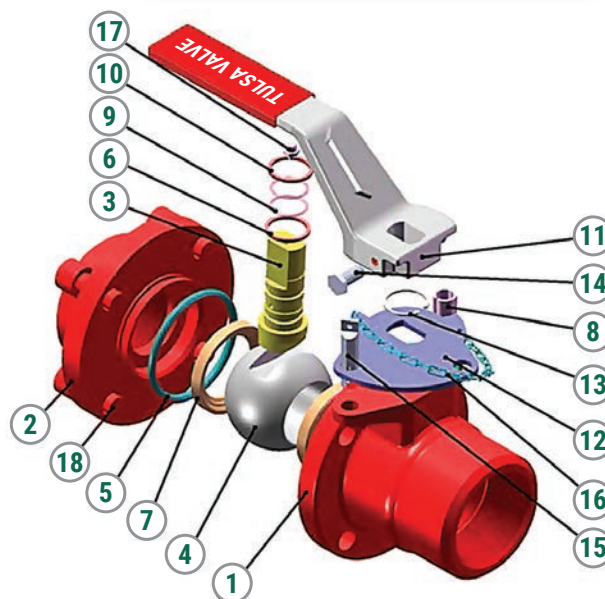

**FIELD PROVEN VALVES PROVIDING YEARS OF
COST EFFECTIVE, EFFICIENT, SAFE AND RELIABLE SERVICE.**



LEADERS IN THE VALVE INDUSTRY

Tulsa Valve is a USA based OEM for a wide range of commonly used valves. The increasing demands to design valves that are more efficient, along with ease of operation, have put Tulsa Valve into a leading position in the industry.



GUARANTEED AGAINST DEFECTS



Tulsa Valve products are guaranteed against defects of material workmanship for One (1) Year from date of invoice provided such products are used normally and within the service and pressure range for which they were manufactured. This guarantee is limited to the repair, replacement or repayment of purchase price. Under no conditions will Tulsa Valve be liable for claim of labor for removal, repair or replacement of Tulsa Valve products, or any other consequential damage.

HOUSTON, TEXAS
TEL: (281) 909-3711 • FAX: (281) 306-2526
WWW.TULSAVALVE.COM